

SPEEDOMETER DRIVES

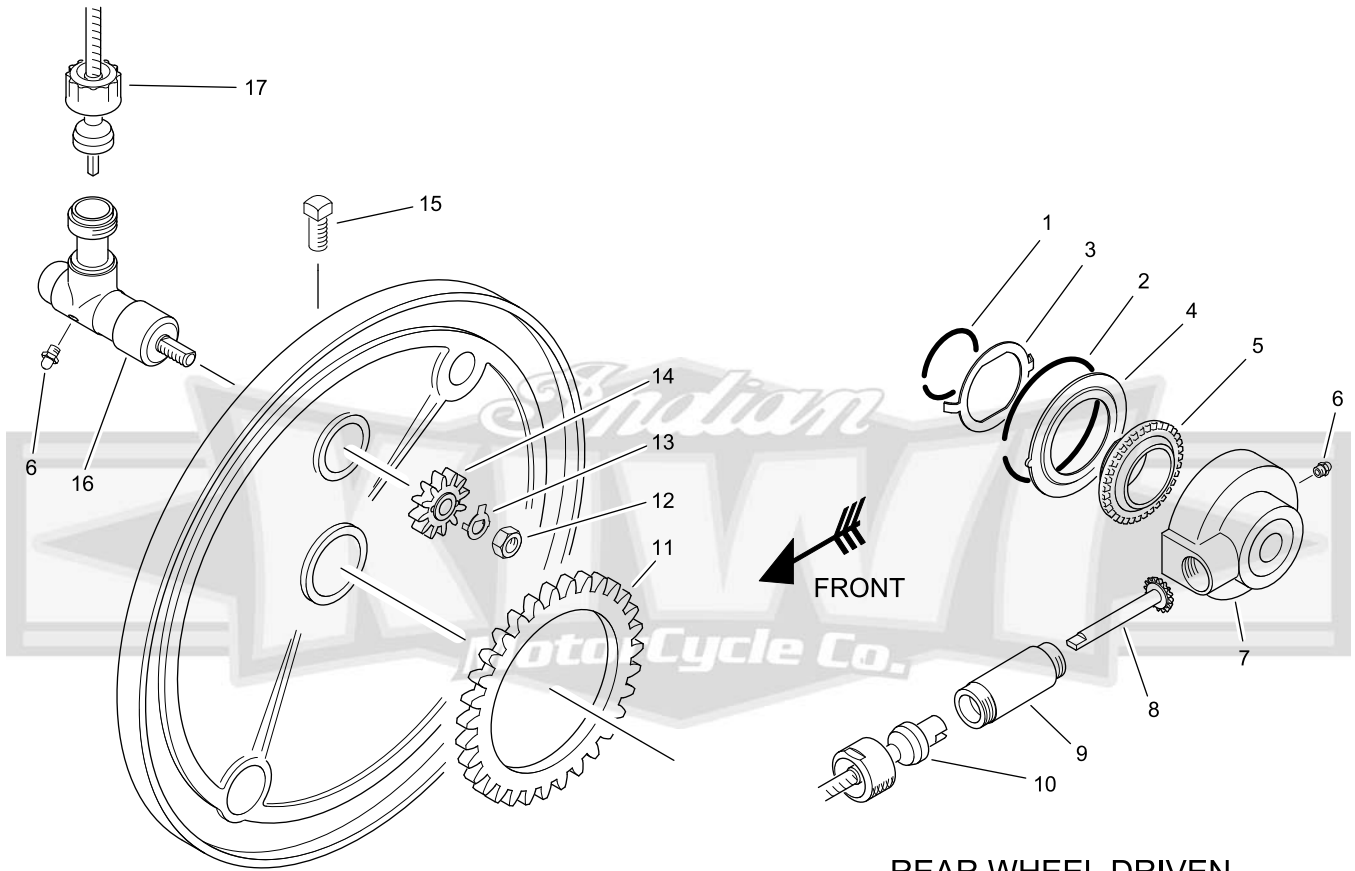

FRONT WHEEL DRIVEN
1948-51

REAR WHEEL DRIVEN
1932-47 and 1952-53
(also used on 1948-51 Police models)

SPEEDOMETER DRIVE PARTS

NOTE: We did not call out years for the individual parts of the rear wheel speedometer drive as they need to be matched to the correct drive unit and wheel size.

REF.	PART NO.	DESCRIPTION	QTY.	YEAR
1	100298	Snap Ring - Small (drive gear to housing washer)	1	—
2	100295	Snap Ring - Large (housing washer to drive housing) <i>NOTE: Kiwi snap rings are of an improved flat design so as to positively hold the mating parts in their respective locations. Original style snap rings were round in shape and easily became dislodged.</i>	1	—
3	100297	Washer - Drive (tabbed)	1	—
4	100294	Washer - Housing (stepped)	1	—
5	100296	Gear - Drive (48 tooth)	1	—
*	100308	Gear - Drive (50 tooth)	1	—
6	416002	Fitting - Grease	1	—
7	100289	Speedometer Drive Unit (48 tooth drive gear - includes ref. 1-9) <i>NOTE: 48 tooth drive gear units suit motorcycles with 400 x 18 and 500 x 16 tires.</i>	1	—
*	100307	Speedometer Drive Unit (50 tooth drive gear - includes ref. 1-9) <i>NOTE: 50 tooth drive gear units suit motorcycles with 450 x 18 tires.</i>	1	—
8	100299	Pinion Gear & Shaft Assembly (mates with 48 tooth drive gear)	1	—
*	100309	Pinion Gear & Shaft Assembly (mates with 50 tooth drive gear) <i>NOTE: Both pinion gears have 15 teeth but differ in the distance from the end of the shaft to mate with the different drive gears.</i>	1	—
9	100293	Housing - Pinion Gear	1	—
10	35L359X	Speedometer Cable (original 5/8" diameter, cloth covered)	1	32-34
*	35L359XR	Speedometer Cable (replacement 1/4" diameter)	1	32-34
*	100789	Speedometer Cable (original 5/8" diameter, cloth covered)	1	35-37
*	100789R	Speedometer Cable (replacement 1/4" diameter)	1	35-37
*	75262	Speedometer Cable (original 5/8" diameter, cloth covered)	1	38-39
*	75262R	Speedometer Cable (replacement 1/4" diameter)	1	38-39
*	75262S	Speedometer Cable (original 5/8" diameter, cloth covered)	1	40-42
*	277002	Speedometer Cable (replacement 1/4" diameter)	1	40-42
*	277002	Speedometer Cable	1	40-47
*	277002	Speedometer Cable <i>NOTE: Original cables through 1942 had a large 5/8 diameter cable and were cloth covered. Post 1942 Indians cables were reduced to 1/4" diameter (which also had a smooth operating inside flexi cable) and did not have any external covering. During Indians days of being in business, if your earlier model broke a cable, the factory replacement was the smaller 1/4" diameter cable. For this reason we also offer a replacement series cable just like Indian did back in the day.</i>	1	52-53
*	40403	Clip - Speedometer Cable (long - at fuel tank mounting bolt) <i>NOTE: This clip fits the original style large 5/8" diameter speedometer cables. An adapter spacer will necessary when using Indians later style smaller diameter cable.</i>	1	38-42
*	36B332	Clip - Speedometer Cable (to frame under seat)	1	38-47
11	239017G	Gear - Drive (31 tooth - mounts to front brake drum) <i>NOTE: Chief models use a 31 tooth drive gear while 741 models use a 32 tooth drive gear. Use the correct gear to obtain the correct speedometer reading.</i>	1	48-51
12	605008	Nut - Jam 1/4-28	1	48-51
13	102746	Tab - Pinion Gear Locking	1	48-51
14	102805	Gear - Pinion (12 tooth) <i>NOTE: Chief models use a 12 tooth pinion gear while 741 models use a 13 tooth pinion gear. Use the correct gear to obtain the correct speedometer reading.</i>	1	48-51
15	852122	Set Screw - Square Hd. 1/4-20 x 1/2"	1	48-51
16	388002	Speedometer Drive Unit (includes ref. 6, & 12-14)	1	48-51
*	388002G	Speedometer Drive Gear Set (inside drive unit)	1	48-51